

## Customized Bearing

## RV reducer taper roller bearing-

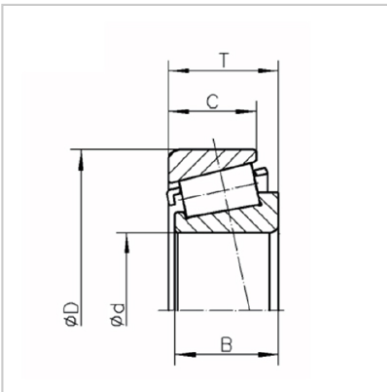

|               |                  |
|---------------|------------------|
| Bearings      | 30204            |
| ID            | 20               |
| OD            | 47               |
| Height T      | 15               |
| ID height B   | 14               |
| Od height C   | 12               |
| Inner Chamfer | 1.5              |
| outer chamfer | 1.5              |
| Loading Cr    | 28.2KN           |
| Loading Cor   | 30.6KN           |
| Notes         | Robot RV reducer |



The miniature taper roller bearing mainly use in RV reducers , it's one of the key components of the RV reducers. It is designed with compact dimensions and consists of an inner ring, an outer ring, rollers, and a cage. It can be used in a compact RV reducer , meeting the requirements of RV reducer for bearings to bear radial and axial combined loads, high rigidity, impact resistance, wear resistance, impact resistance, and long service life.



MONTON use high quality materials and manufacturing processes to ensure bearing stability and durability under high loads and high speed. The tapered roller bearings installed in the RV gearbox need to balance high precision and high reliability to ensure stable operation under heavy load and high rigidity conditions. MONTON miniature tapered roller bearings are widely used in the transmission systems of industrial robot joints, RV reducers, and harmonic reducers. They are one of the main supporting components for RV reducers to achieve high positioning accuracy and stable output. Welcome contact with us for more information!

|                  |           |     |      |      |      |
|------------------|-----------|-----|------|------|------|
| RV-20E           | 89        | 114 | 13   | 12   | 13   |
| RV-40E           | 115       | 145 | 15   | 14   | 15   |
| RV-80E           | 131       | 165 | 15   | 11   | 15   |
| RV-110E          | 144       | 174 | 15   | 14   | 15   |
| RV-160E          | 168       | 205 | 19   | 15.4 | 20   |
| RV-320E          | 200       | 250 | 23   | 20.5 | 24   |
| RV-10C           | 97        | 120 | 13   | 12   | 13   |
| RV-120C          | 182       | 214 | 17.5 | 15   | 17.5 |
| RV-320CA         | 320       | 383 | 30   | 29.8 | 30   |
| RV-20E<br>RV-25  | 33001-9.4 | 9.4 | 24   | 13   |      |
| RV-20E<br>RV-25  | 33001     | 10  | 24   | 13   |      |
| RV-20E<br>RV-42N | A2125/10  | 12  | 27   | 13   |      |

|  |          |    |    |       |  |
|--|----------|----|----|-------|--|
| RV-20E<br>RV-42N                         | 30301    | 12 | 27 | 13    |  |
| RV-50C                                   | 30202*2J | 12 | 30 | 12.7  |  |
| RV-50C                                   | 32102    | 15 | 30 | 13.1  |  |
| RV-50E                                   | 30202U   | 15 | 35 | 11.75 |  |
| RV-80E<br>RV-70F<br>RV-120C              | 32202    | 15 | 35 | 15    |  |
| RV-80E<br>RV-70F<br>RV-120C              | 32202X1  | 15 | 36 | 15    |  |
| RV-110E<br>RV-110F<br>RV-120F<br>RV-200C | 32004U   | 15 | 42 | 15    |  |
| RV-160E<br>CR-320C                       | 30204U   | 20 | 47 | 15    |  |
| RV-320CA<br>CR-400C                      | 32204U   | 20 | 47 | 15.25 |  |
| RV-320E<br>RV-500C                       | 33006U   | 20 | 55 |       |  |
| RV-320E<br>RV-500C                       | 33006X2  | 30 | 58 | 20    |  |
| RV-320E<br>RV-500C                       | 32006X2J | 30 | 58 | 19.7  |  |
| RV-450E                                  | 32206X3  | 30 | 65 | 20    |  |
| RV-320E3                                 | 32206U   | 30 | 62 | 22    |  |
| RV-550E<br>RV-550F                       | 32207    | 35 | 72 | 24.25 |  |